

The 12th Annual CAPA Diagnostic Course

Chinese American Pathologists Association

**Saturday, September 12 &
Sunday, September 13, 2026**

Four Points by Sheraton Flushing, NY





The 12th Annual CAPA Diagnostic Course

Date: September 12-13, 2026

Location: Four Points by Sheraton Flushing

Address: 33-68 Farrington St, Flushing, NY 11354

Organized by: Chinese American Pathologists Association (CAPA)

Organizing Committees:

Scientific Committee:

Chair: Deyin Xing

Co-Chairs: Shaoxiong Chen, Rong Xia, Zenggang Pan

Members: Lihong Bu, Liam Chen, Jinjun Cheng, Yi Ding, Shunyou Gong, Huihua Li, Xiaoyan Liao, Zhonghua Liu, Qiuying Shi, Tong Sun, Tiannan Wang, Shaofeng Yan, Xin Yi, Limin Yu, Gloria Zhang, Miao Zhang, Helen Zhang, Bihong Zhao

CME Application Committee:

Chair: Rong Xia

Co-Chairs: Xiaoyan Liao, Guang (Jeff) Yang

CAPA Executive Committee:

President: Zenggang Pan

Members: Shaoxiong Chen, Yi Ding, Yanjun Hou, Xiaoying Liu (President-elect), Jinming Song, Deyin Xing

Meeting Logistics and Organizing Team:

Chair: Rong Xia

Co-Chairs: Yanjun Hou, Peng Lee

Members: Xiaoyan Huang, Bingyu Li, Naijia Liu, Qian Wan, Xiaowei Wei, Jiye Zhu, Sifan Zou

Conference Overview:

The 12th Annual CAPA Diagnostic Course (Saturday, September 12 & Sunday September 13, 2026) (Registration at CAPA website: <https://www.capa-ht.org>)

The 12th Annual CAPA Diagnostic Course is a one and half day conference on Saturday, September 12 & Sunday, September 13, 2026, bringing together leading experts across all subspecialties of diagnostic pathology to provide comprehensive education on recent advances in diagnostic pathology, molecular testing, and cutting-edge technology applications in pathology. The course focuses on updates in disease classifications and common diagnostic challenges encountered in daily practice. It features didactic lectures and case-based presentations, offering participants practical insights to enhance their diagnostic accuracy and confidence.

Learning Objectives

Upon completion of this course, participants will be able to:

1. **Enhance Diagnostic Accuracy:** Strengthen the ability to interpret and diagnose complex pathology cases across subspecialties by mastering pathologic classifications, recognizing common pitfalls, and applying advanced diagnostic techniques to improve clinical outcomes.
2. **Stay Abreast of Emerging Trends:** Stay informed on the latest advancements in diagnostic pathology, including molecular testing, and cutting-edge technologies, to remain at the forefront of the field.
3. **Refine Case-Based Diagnostic Skills:** Improve diagnostic precision and reduce errors by engaging in case-based learning, analyzing challenging scenarios, and leveraging in-depth discussions to navigate complex clinical situations effectively.
4. **Promote Collaborative Learning:** Foster a collaborative environment for networking with peers and experts to exchange insights, share best practices, and enhance overall diagnostic proficiency and patient care through collective knowledge-building.

Intended Audience

This course is intended for:

- Practicing pathologists seeking to enhance their diagnostic skills
- Pathology residents, fellows, and trainees preparing for board exams or subspecialty practice
- Healthcare professionals involved in pathology and related diagnostic fields

Registration Fees

- Non-member: \$300
- Member: \$200
- Speakers and moderators for concurrent sessions: \$100
- Speakers for general sessions: Free
- Associate Member / Pre-resident Attendee / Guest (for dinner reception only): \$100

Donations to CAPA, a 501(c)(3) non-profit organization, are welcome and appreciated.

CME Information

Joint Providership & Accreditation Statement

The 12th CAPA Diagnostic Course has been planned and implemented in accordance with the accreditation requirements and policies of the Accreditation Council for Continuing Medical Education (ACCME) through the joint providership of the College of American Pathologists (CAP) and the Chinese American Pathologists

Association (CAPA). The CAP is accredited by the ACCME to provide continuing medical education for physicians.

Credit Designation Statement

The College of American Pathologists designates this live educational activity for a maximum of 11 *AMA PRA Category 1 Credit(s)*[™]. Physicians should claim only the credit commensurate with the extent of their participation in the activity.

Disclaimer

The content of this accredited CE (CME) activity does not necessarily reflect the views or policies of the College of American Pathologists.

Meeting Agenda

9/12/2026 Saturday, 7:00 AM-5:00 PM registration

9/12/2026 Saturday Morning Sessions (New York City Local Time)

Concurrent session #1 (Queens A): Breast Pathology

Moderator: Dr. Gloria Zhang

8:00-8:25 AM DCIS diagnosis and beyond. By Dr. Ping Tang, Cook County Health

8:25-8:50 AM Pitfalls in Breast Sclerosing Lesion. By Dr. Hua Guo, UAB School of Medicine

8:50-9:15 AM Pathologic Evaluation of Neoadjuvant Treated Breast Cancer. By Dr. Yihong Wang, Brown University

9:15-9:40 AM Lessons from breast pathology consults. By Dr. Gloria Zhang, Cleveland Clinic

9:40-9:55 AM Break

Concurrent session #1 (Queens A): Gynecologic Pathology

Moderator: Dr. Yanjun Hou and Dr. Tong Sun

9:55-10:20 AM Rare variants of endometrial carcinoma. By Dr. Tong Sun, Yale School of Medicine

10:20-10:45 AM Miscellaneous uterine mesenchymal tumor. By Dr. Shi Bai, University of Massachusetts Chan Medical School

10:45-11:10 AM The common, uncommon and rare lesions in the uterine cervix. By Dr. Yanjun Hou, Wake Forest University School of Medicine

11:10-11:35 AM Ovarian adult granulosa cell tumor and Sertoli Leydig cell tumor: diagnosis and differential diagnosis. By Dr. Deyin Xing, Johns Hopkins University School of Medicine

Concurrent session #2 (Queens B): GU Pathology

Moderator: Dr. Jianhong Li

8:00-8:25 AM Expect the unexpected: practicing as a genitourinary pathologist. By Dr. Liwei Jia, University of Texas Southwestern Medical Center

8:25-8:50 AM Testicular tumor: the usual suspects and the rare outlier. By Dr. Lan Zheng, University of Texas Southwestern Medical Center

8:50-9:15 AM When the microscope is not enough: diagnostic pitfalls in renal cell carcinoma. By Dr. Jenny (Jianling) Tu, Weill Cornell Medicine

9:15-9:40 AM Diagnostic challenges in recurrent prostatic carcinoma. By Dr. Xiangtian (Max) Kong, Kaiser Sacramento Med Center

9:40-9:55 AM Break

Concurrent session #2 (Queens B): Gastrointestinal, Hepatobiliary and Pancreatic Pathology

Moderator: Dr. Wendy Cao and Dr. Lihui Qin

9:55-10:20 AM The Second Look: Avoiding Pitfalls in Atypical Morphologies of a GI tumor. By Dr. Yansheng Hao, Dartmouth Health/Geisel School of Medicine

10:20-10:45 AM Clinicopathological and molecular characterization of melanoma metastatic to the gastrointestinal tract. By Dr. Bing Ren, Dartmouth Hitchcock Medical Center

10:45-11:10 AM Uncommon liver tumors: morphologic clues and diagnostic pearls. By Dr. Xiaofei Zhang, NYU School of Medicine

11:10-11:35 AM Pancreatic neuroendocrine neoplasms: tips for daily practice. By Dr. Hannah Chen, Mass General Brigham

Concurrent session #3 (Queens C): Cytopathology

Moderator: Dr. Hannah Chen and Dr. Haijun Zhou

8:00-8:25 AM Windows to Disease: The Art and Science of Serous Fluid Cytopathology. By Dr. Helen Zhang, The University of Texas Health Science Center at Houston

8:25-8:50 AM Rare Entities and Near-Miss Cases in Cytopathology. By Dr. Sanhong Yu, Yale School of Medicine

8:50-9:15 AM Diagnostic Approach to Pancreatic Cystic Lesions: Recommendations from the WHO Reporting System for Pancreaticobiliary Cytopathology. By Dr. Minhua Wang, Yale School of Medicine

9:15-9:40 AM Cytopathology of Solid Pancreatic Neoplasms: A Stepwise Practical Approach to Diagnosis. By Dr. Qun Wang, Emory University School of Medicine

9:40-9:55 AM Break

Concurrent session #3 (Queens C): Hematopathology

Moderator: Dr. Shunyou Gong and Dr. Helen Zhang

9:55-10:20 AM Hemepath consultation in gastrointestinal biopsies: when, why, and what it changes. By Dr. Yanhua Wang, Montefiore Medical Center/Albert Einstein College of Medicine

10:20-10:45 AM T-Cell Neoplasms Primarily Involving Blood and Bone Marrow: Key Diagnostic Features. By Dr. Hong Fang, MD Anderson Cancer Center/University of Texas Houston

10:45-11:10 AM Plasma Cell Neoplasms: Diagnostic Challenges and Pitfalls. By Dr. Yang Shi, Montefiore Medical Center/Albert Einstein College of Medicine

11:10-11:35 AM TdT+ Blastoid B-cell Neoplasm: Immature or Mature? By Dr. Lianqun Qiu, MD Anderson Cancer Center/University of Texas Houston

11:35 AM-1:30 PM Lunch Break (lunch provided)

Non-CME activity 12:05-1:00 PM Sponsor presentation (Queens A)

Non-CME activity 12:05-1:00 PM Leadership session (Queens B, Organizer: Dr. Qiuying Shi and Dr. Bing Ren)

Early Career Development & Leadership Foundations

Panelist mentors/speakers: Dr. Lirong Cheng (Kaiser Permanente), Dr. Peng Ji (Northwestern University), Dr. Qiuying Shi (Oregon Health & Sciences University), and Dr. He Wang (Stony Brook School of Medicine)

9/12/2026 Saturday Afternoon Sessions (New York City Local Time)

Concurrent session #4 (Queens A): Autopsy/Forensic Pathology, Neuropathology

Moderator: Dr. Bihong Zhao and Dr. Liam Chen

1:30-2:00 PM Learning aortic pathology from an autopsy case. By Dr. Bihong Zhao, McGovern Medical School

2:00-2:30 PM Brain Banking: a brief introduction. By Dr. Xinhai Zhang, McGovern Medical School

2:30-3:00 PM Intraoperative diagnosis in surgical neuropathology. By Dr. Liam Chen University of Minnesota

3:00-3:25 PM Break

Concurrent session #4 (Queens A): Clinical Pathology, Informatics/Digital Pathology

Moderator: Dr. Xin Yi and Dr. Xiaoying Liu

3:25-3:50 PM Laboratory Medicine Empowering patient-centered transplant medicine. By Dr. Xin Yi, Houston Methodist Hospital

3:50-4:15 PM Clinical Mass Spectrometry in Precision Drug Therapy: From Drug Measurement to Personalized Care. By Dr. Fang Wu, Mass General Brigham

4:15-4:40 PM AI in Cytology: Where Digital Meets Diagnostic. By Dr. Xiaoying Liu, Dartmouth Hitchcock Medical Center

4:40-5:05 PM Digital Pathology and AI in the Real World: Lessons from a Practicing Pathologist and AI Developer. By Dr. Limin Yu, Oakland University (non-CME presentation)

Concurrent session #5 (Queens B): Cardiothoracic pathology, Head & neck pathology

Moderator: Dr. Qiuying Shi and Dr. Sanhong Yu

1:30-1:55 PM When More Isn't Better: The Elusiveness of Diagnosing Certain Lung Tumors. By Dr. Haijun Zhou, Houston Methodist Hospital

1:55-2:20 PM Thymic lesions: Practical pitfalls and diagnostic traps. By Dr. Min Zhang, Beth Israel Deaconess Medical Center

2:20-2:45 PM It's a trap! Diagnostic pitfall in frozen evaluation of sinonasal lesions. By Dr. Tieying Hou, Indiana University

2:45-3:10 PM It's a trap! Squamous cell carcinoma: when it is and isn't. by Dr. Li Lei, University of California San Diego

3:10-3:25 PM Break

Concurrent session #5 (Queens B): Bone and soft tissue pathology, dermatopathology

Moderator: Dr. Shaoxiong Chen and Dr. Shaofeng Yan

3:25-3:50 PM Interesting soft tissue cases- evolving entities. By Dr. Wei Jiang, Thomas Jefferson University

3:50-4:15 PM Soft tissue tumors with melanocytic differentiation. By Dr. Zhonghua Liu, MedStar Washington Hospital Center

4:15-4:40 PM Overview of Cutaneous Lymphomas. By Dr. Joyce Chen, Memorial Sloan Kettering Cancer Center

4:40-5:05 PM Update of Melanocytic Lesions. By Dr. Christine Lian, MGB, Harvard Medical School

Concurrent session #6 (Queens C): Molecular pathology, renal pathology

Moderator: Dr. Yi Ding and Dr. Ming Wu

1:30-1:55 PM Casting a Wider Net: Expanded NGS Uncovers a Rare FAS Variant with Clinical Impact. By Dr. Guang (Geoff) Yang, University of Pennsylvania

1:55-2:20 PM From Slide to Sequence: How Molecular Pathology Is Reshaping Surgical Pathology. By Dr. Gord Guo Zhu, Cooper Medical School of Rowan University

2:20-2:45 PM More Than Meets the Eye: Decoding Interstitial Inflammatory Lesions in the Medical Kidney Biopsies. By Dr. Liye Suo, SUNY Upstate Medical University

2:45-3:10 PM Evaluation of non-neoplastic kidney parenchyma in nephrectomy specimens. By Dr. Yihe Yang, Weill Cornell Medical College

3:10-3:25 PM Break

Concurrent session #6 (Queens C): Pediatric pathology, immunohistochemistry

Moderator: Dr. Qian Wang and Dr. Rong Xia

3:25-3:55 PM Wilms tumor: what we can do in pathology? By Dr. Qian Wang, UPMC Children's Hospital of Pittsburgh

3:55-4:25 PM Aggressive hematopoietic malignancy with INI1 deficiency: T and/or beyond T lineage? By Dr. Yanna Ding, UAB School of Medicine

4:25-4:55 PM The diagnostic correlation between molecular analysis and immunohistochemistry. By Dr. Jing Xu, UT Southwestern Medical Center

8:00 AM-5:05 PM Non-CME trainee session (Queens D, Organizer: Dr. Tianle Zou)

8:00- 9:40 AM Residency application talk and onsite interaction:

Title: Beyond Scores and CVs: What Makes a Strong Pathology Residency Applicant

Presenter: Dr. Sabina Hajiyeva (residency program director, Northwell Health Lenox Hill Hospital, NYC)

Talk followed by QA session

Host: Dr. Sifan Zou

9:40-9:55 AM Break

9:55 AM – 12:00 PM: Pathology resident applicants' mock interview: Interviewee & Interviewer (including Dr. Hajiyeva)

12:00 PM -1:30 PM Lunch Break (lunch provided)

1:30-3:10 PM Job application talk (hybrid format—in person and zoom meeting)

Title: How to prepare for Pathology job interview? Covering jobs in academic, community, and company settings.

Presenters: Dr. Huanyou Wang, Dr. Lirong Cheng, Dr. Guofeng Gao

Host: Dr. Mengxue Zhang; Moderator: Dr. Tianle Zou

3:10-3:25 PM Break

3:25-5:05 PM: Resident/fellow abstract oral presentation

Moderator: Dr. Hanqiao Zheng and Dr. Ting Zhao

5:05 - 5:30 PM: Group Photos

7:00 - 9:00 PM: Dinner Reception / Party

Banquet rooms located at:

Four Points by Sheraton

33-68 Farrington Street, Flushing, NY 11354

9/13/2026 Sunday (New York City Local Time)

7:50-8:00 AM Welcome remarks by CAPA president Dr. Zenggang Pan and scientific committee chair Dr. Deyin Xing

8:00-8:50 AM Keynote presentation

Moderator: Dr. Deyin Xing

Common Diagnostic Pitfalls in Bladder & Prostate Pathology

Speaker: Dr. Jonathan Epstein, Director, Advanced Urothology Consulting Services

8:55-9:45 AM Keynote presentation

Moderator: Dr. Shaoxiong Chen

HPV-associated head and neck carcinoma: classification, diagnostic pitfalls, and testing guideline

Speaker: Dr. Bin Xu, Associate Attending Pathologist, Memorial Sloan Kettering Cancer Center

9:45-10:00 AM Break

General session

Moderator: Dr. Rong Xia

10:00 -10:30 AM Inflammatory bowel disease and associated neoplasia: diagnostic pitfalls and new WHO updates

Speaker: Dr. Wendy Cao, Professor, NYU School of Medicine

Moderator: Dr. Rong Xia

10:30-11:00 AM Benign Mimics of Hematologic malignancies: Diagnostic Pitfalls

Speaker: Dr. Wei Wang, Associate Professor, MD Anderson Cancer Center

Moderator: Dr. Guoli Chen

11:00-11:30 AM Lung Tumor Pathology: Diagnostic Pitfalls and Practical Pearls

Speaker: Dr. Haodong Xu, Professor, Wake Forest University School of Medicine

Moderator: Dr. Guoli Chen

11:30 AM-12:00 PM Calcified Chondroid Mesenchymal Neoplasm: New Entity or Evolving Concept

Speaker: Dr. Xiaohua Qian, Clinical Professor, Stanford University School of Medicine

Floor Plan and Set-Up

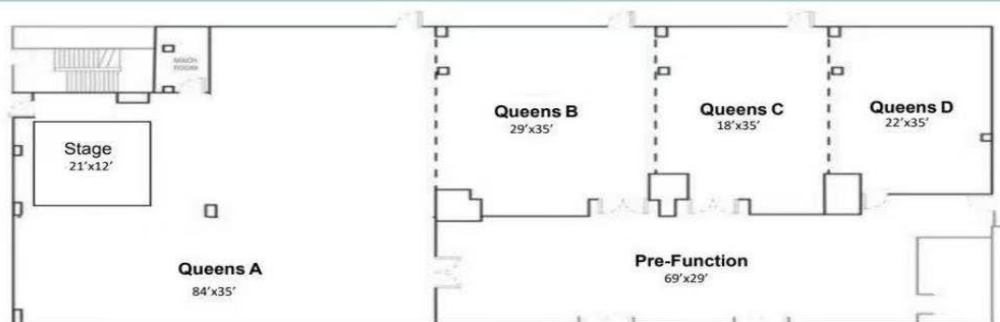

Set-Up Styles	Queens Combined	Queens A	Queens B	Queens C	Queens D
Theater	250	80	60	40	50
Classroom	150	60	40	25	30
Banquet Rounds	200	70	50	30	40
Conference	100	60	40	20	25
Reception	250	80	60	40	50
U-Shape	80	50	30	20	25

*All dimensions and set up are approximate

Faculty list (alphabetically by last name)

Shi Bai, MD, PhD, Assistant Professor, University of Massachusetts Chan Medical School

Wendy Cao, MD, Professor, NYU School of Medicine

Hannah Chen, MD, PhD, Pathologist, Mass General Brigham

Joyce Chen, MD, PhD, Assistant Professor, Memorial Sloan Kettering Cancer Center

Liam Chen, MD, PhD, Professor, University of Minnesota

Yanna Ding, MD, PhD, Assistant Professor, UAB School of Medicine

Jonathan Epstein, MD, Director, Advanced Uropathology Consulting Services

Hong Fang, MD, PhD, Assistant Professor, MD Anderson Cancer Center/University of Texas Houston

Hua Guo, MD, PhD, Associate Professor, UAB School of Medicine

Sabina Hajiyeva, MD, Associate Professor, Zucker SOM at Hofstra/Northwell (Non-CME speaker)

Yansheng Hao, MD, PhD, Assistant Professor, Dartmouth Health/Geisel School of Medicine

Tieying Hou, MD, PhD, Assistant Professor, Indiana University

Yanjun Hou, MD, PhD, Associate Professor, Wake Forest University School of Medicine

Liwei Jia, MD, PhD, Associate Professor, University of Texas Southwestern Medical Center

Wei Jiang, MD, PhD, Professor, Thomas Jefferson University

Xiangtian (Max) Kong, MD, Chief/senior pathologist, Kaiser Sacramento Med Center

Li Lei, MD, PhD, Associate Professor, University of California San Diego
Christine Lian, MD, Associate Professor, MGB/Harvard Medical School
Xiaoying Liu, MD, MS, Associate Professor, Dartmouth Hitchcock Medical Center
Zhonghua Liu, MD, PhD, Staff Pathologist, MedStar Washington Hospital Center
Xiaohua Qian, MD, PhD, Clinical Professor, Stanford University School of Medicine
Lianqun Qiu, MD, PhD, Assistant Professor, MD Anderson Cancer Center/University of Texas Houston
Bing Ren, MD, PhD, Associate Professor, Dartmouth Hitchcock Medical Center
Yang Shi, MD, PhD, Associate Professor, Montefiore Medical Center/Albert Einstein College of Medicine
Tong Sun, MD, PhD, Assistant Professor, Yale School of Medicine
Liye Suo, MD, PhD, Assistant Professor, SUNY Upstate Medical University
Ping Tang, MD, PhD, Chair of Surgical Pathology, Cook County Health
Jenny (Jianling) Tu, MD, PhD, Associate Professor, Weill Cornell Medicine
Minhua Wang, MD, PhD, Assistant Professor, Yale School of Medicine
Qian Wang, MD, PhD, Assistant Professor, UPMC Children's Hospital of Pittsburgh
Qun Wang, MD, PhD, Associate Professor, Emory University School of Medicine
Wei Wang, MD, PhD, Associate Professor, MD Anderson Cancer Center
Yanhua Wang, MD, PhD, Professor, Montefiore Medical Center/Albert Einstein College of Medicine
Yihong Wang, MD, PhD, Professor, Brown University
Fang Wu, PhD, Director, Mass General Brigham
Deyin Xing, MD, PhD, Associate Professor, Johns Hopkins University School of Medicine
Bin Xu, MD, PhD, Associate Attending Pathologist, Memorial Sloan Kettering Cancer Center
Haodong Xu, MD, PhD, Professor, Wake Forest University School of Medicine
Jing Xu, MD, PhD, Assistant Professor, UT Southwestern Medical Center
Guang (Geoff) Yang, MD, PhD, Assistant Professor, University of Pennsylvania
Yihe Yang, MD, PhD, Assistant Professor, Weill Cornell Medical College
Xin Yi, PhD, Associate Professor, Houston Methodist Hospital
Limin Yu, MD, MS, Assistant Professor, Oakland University (non-CME speaker)
Sanhong Yu, MD, Assistant Professor, Yale School of Medicine
Gloria Zhang, MD, MPH, Associate Professor, Cleveland Clinic
Helen Zhang, MD, Associate Professor, The University of Texas Health Science Center at Houston
Min Zhang, MD, PhD, Assistant Professor, Beth Israel Deaconess Medical Center
Xiaofei Zhang, MD, Assistant Professor, NYU School of Medicine
Xinhai Zhang, MD, PhD, Associate Professor, McGovern Medical School
Bihong Zhao, MD, PhD, Associate Professor, McGovern Medical School
Lan Zheng, MD, PhD, Assistant Professor, University of Texas Southwestern Medical Center
Haijun Zhou, MD, PhD, Associate Professor, Houston Methodist Hospital
Gord Guo Zhu, MD, PhD, Associate Professor, Cooper Medical School of Rowan University